

Y-Strainer

Scope of Use / Specification Sheet

RMC's Y-Strainers provide downstream protection from dirt and debris. Available with female threaded connections.

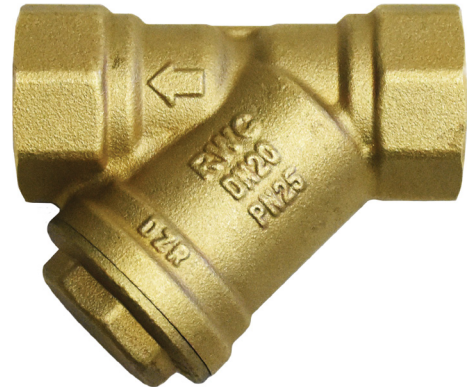

YX20

Product List

Order Code	Description
YX15	15mm (1/2") Y-Strainer
YX20	20mm (3/4") Y-Strainer
YX25	25mm (1") Y-Strainer
YX32	32mm (1 1/4") Y-Strainer
YX40	40mm (1 1/2") Y-Strainer
YX50	50mm (2") Y-Strainer

Features and Benefits

- Robust DZR brass body
- Easily removable cap for strainer access and cleaning
- 600 micron mesh to catch debris and impurities in the water
- Meets Australian Standard for potable water supply
- Every valve is tested to ensure high quality and performance

Application

The RMC Y-Strainers can be installed upstream of any valve that requires protection from dirt and debris. The Y-Strainer should be installed with the arrow marking on the body in line with the system's flow direction. Easy access to the strainer cap is required for removal and cleaning.

Installation Conditions

Working Temperature Range	0°C to 99°C
Maximum Working Pressure	2000kPa
Mesh Size	600 microns

Standards and Approvals



Lead Free

AS 3688
WM-0979

Y-Strainer

Dimensions

Order Code	A	B	C
YX15	Rp 1/2" Female	41	62
YX20	Rp 3/4" Female	49	73
YX25	Rp 1" Female	59	89
YX32	Rp 1 1/4" Female	69	103
YX40	Rp 1 1/2" Female	75	114
YX50	Rp 2" Female	90	136

Note: All measurements in mm unless otherwise stated.

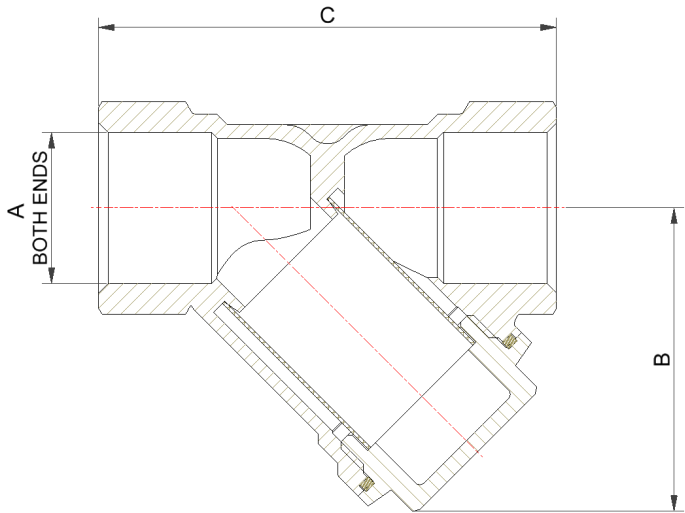

Installation

Installation is subject to the requirements of the applicable regulatory authority, the National Construction Code Volume Three – Plumbing Code of Australia, associated reference standards as applicable at the time and AS/NZS 3500. This product is compliant to the Lead Free requirements of the National Construction Code Volume Three. For further Scope of Use, please visit www.rmc.com.au/resources.

Materials

Body	Lead Free DZR Brass
Cap	Lead Free DZR Brass
Strainer	Stainless Steel
Seals	PTFE

Warranty

Reliance Worldwide Corporation (Aust.) Pty. Ltd. (RWC) will either replace or repair any defective goods where the defect arose as a result of manufacture within the warranty period. You may contact RWC at the phone number, address or e-mail shown below for further information or to make a claim.

Visit www.rmc.com.au/warranty to view the warranty statement in full and for further important information.